



The Educational Benefits of Flexible Learning Spaces

January 17, 2018



© 2018 Hoffman Planning, Design & Construction, Inc.

Presenters



Robert Eidahl, Ed. D.
District Administrator
Berlin Area School District



Robert Koehler, AIA, NCARB
Project Architect
Hoffman Planning, Design & Construction, Inc.

Berlin Area Schools (prior to 2011)

- Clay Lamberton Elementary School
 - EC-Grade 5
- Poy Sippi Elementary School
 - EC-Grade 4
 - Closed in 2011
- Berlin Middle School
 - 100 year old with 60 and 30 year old additions
- Berlin High School
 - Completed in 1996



Development of Options

- Seven different options were evaluated with cost estimates

Scenario D – Add Middle School to High School

- Add Middle School for Grades 6-8 to existing High School, including wrestling and fitness rooms
 - New Area: 90,000 SF @ \$160→\$185 per SF
 - Estimated Cost: \$14,400,000→\$16,650,000
- Add 5 kindergarten rooms and secure entrance at Clay Lamberton Elementary School
 - New Area: 10,750 SF @ \$150→\$190 per SF
 - Renovated Area: 13,300 SF @ \$45→\$65 per SF
 - Estimated Cost: \$2,211,000→\$2,907,000
- Possibly deconstruct existing Middle School
 - Existing Area: 138,686 SF @ \$6→\$7 per SF
 - Estimated Cost: \$832,116→\$970,802
- Total: \$17,443,116→\$20,527,802



\$18,700,000 referendum passed in October, 2013 with 76% voting in favor!

Key Considerations and Constraints

- Distinct identity for the Middle School
- Very tight site
 - Compact, "boxy" design
- Very tight budget
 - Careful evaluation of options for:
 - Building layout
 - Sustainable design elements
 - Selection of Furniture, Fixtures, & Equipment
- 21st Century Learning concepts
 - In what form?
- Conservative community and resistance from some High School teachers
 - Concerns about adding grades 6-8 to high school



5



Evolution of Work & Learning Spaces

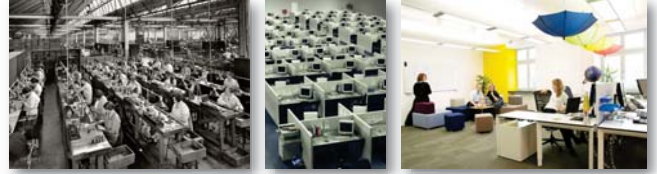

6



21st Century Learning Environments

Provide a variety of options for:

- Direct instruction
- Tutoring
- Individual study
- Collaboration/group discussion
- Research
- Presentations
- Access to technology
- Individualized learning

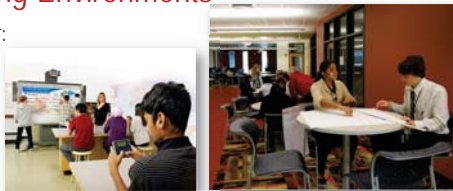

7



Flexible Furniture Layouts



900 SF Classroom – 24 Students – Same Furniture

8



Berlin Middle & High Schools

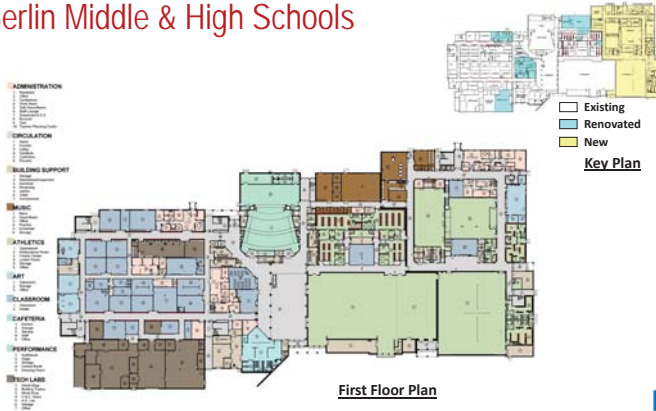

Berlin Middle & High Schools

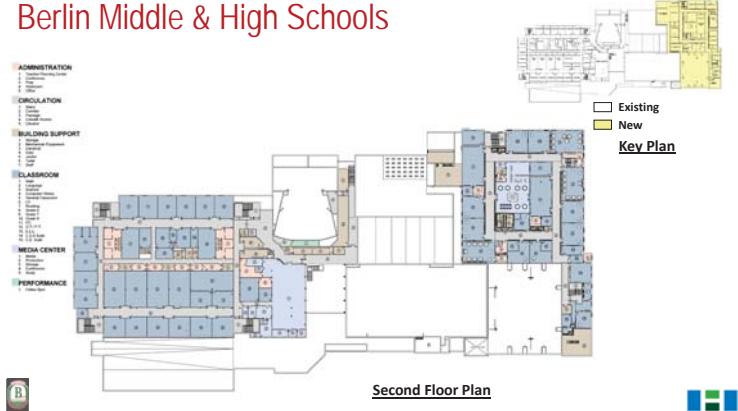

Math Lab

- Grades 6, 7 & 8 in one room
- Individualized learning
- Small and medium-size break-out rooms
- Multiple furniture options

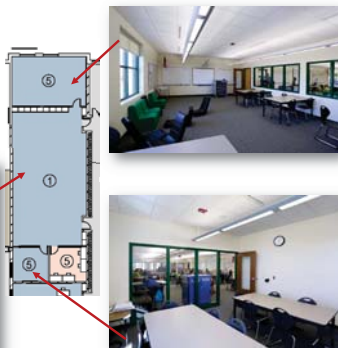

11

Language Arts Lab

- Adjacent to LMC
- Larger break-out room used for Reading

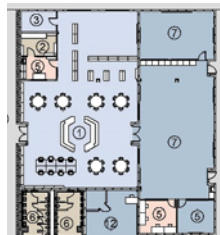

12

Flexible Classroom Layouts

- Triangular tables with separate chairs can easily be configured multiple ways for:
 - Group work / collaboration
 - Direct instruction
 - Testing



13

Science labs

- Perimeter casework with plumbing
- Movable tables for flexibility
 - Adjustable height
 - Double as lab tables for experiments
- Less crowded room



Traditional



7th Grade



6th Grade



8th Grade

14

Art Room

- Natural light
- Storage
- Sinks
- Teaching wall
- Display



15

Music

- Multiple rooms for band and vocal
- Instrument storage in hallway
- Space for movement, writing, and singing



16



16

Fitness

- New 2-station M.S. gym
- Existing 3-station H.S. gym
- Cardio / weights room
- Multi-purpose room
 - Wrestling w/mat storage
 - Cheerleading
 - Batting cages
 - Other
- Multiple locker rooms
 - H.S.
 - M.S.
 - Community
- Health and Phy. Ed. classrooms



17



Fitness



18



Impact of the new Middle School Addition

- Students and staff are very proud of their building.
- The community loves how the two buildings came together.
- Few if any problems with middle school and high school students mixing.
- New math program saw an average 2.3 year growth in students in all three grades based on Star Achievement data.
- Enhanced science opportunities.
- Fitness center is a great success.
- Wonderful place to hold tournaments for basketball, volleyball, and wrestling. Visitors rave about facilities.

19



Clay Lamberton Elementary School

- Addition of 5 Kindergarten classrooms
- Improved Special Needs classrooms
- Improved Art and Music rooms
- Multi-Purpose Science / Activity Room

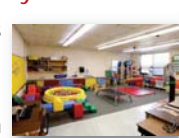

First Floor Plan

20



Seating Options

- Variety of options
- Support some movement



21



Introducing Flexible Furniture Options



22



Questions?

